

Cap Information

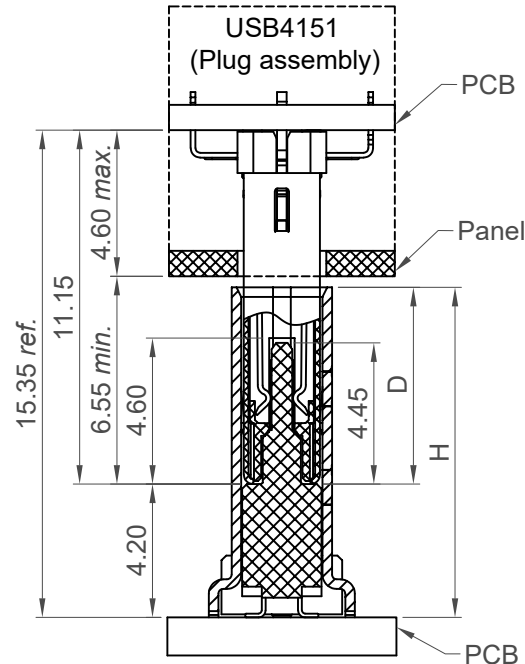

USB4220 (Receptacle)
Plug and Receptacle Mating View

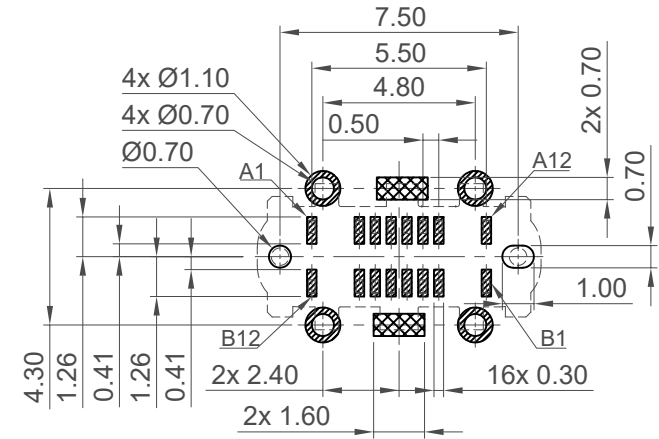

Recommended PCB Layout

Thickness 1.20±0.10mm

Tolerance: ±0.05mm

▨ Solder Area ▩ Keep Out Area □ Component Outline

TABLE

Dimensions	
H	D
8.80	4.60
9.30	5.10
10.00	5.80
10.40	6.20

Pin	Signal	Mating Sequence	Pin	Signal	Mating Sequence
A1	GND	First	B12	GND	First
A4	V _{BUS}	First	B9	V _{BUS}	First
A5	CC1	Second	B8	SBU2	Second
A6	Dp1	Second	B7	Dn2	Second
A7	Dn1	Second	B6	Dp2	Second
A8	SBU1	Second	B5	CC2	Second
A9	V _{BUS}	First	B4	V _{BUS}	First
A12	GND	First	B1	GND	First
SHELL		GND	SHELL		GND

Part Number USB4220		Product Description USB2.0 Type C Receptacle, Vertical, SMT, 16Pin	
Drawing Date 27th June 2024			
By KY	Drawing Release	Tolerances (Except as Noted) Length X.X ± 0.30 X.XX ± 0.25 X.XXX ± 0.10	Units: Metric (mm)
Detail	Revision A	-	3rd Angle Projection
Revision Date	27/06/24		
		RoHS COMPLIANT 2011/05/UE	
		This drawing is confidential and copyright of Global Connector Technology, Ltd (GCT). This drawing must not be copied or disclosed without written consent. E & OE	
		Not to Scale	
		Drawn By KY	
		Sheet No. 2/3	



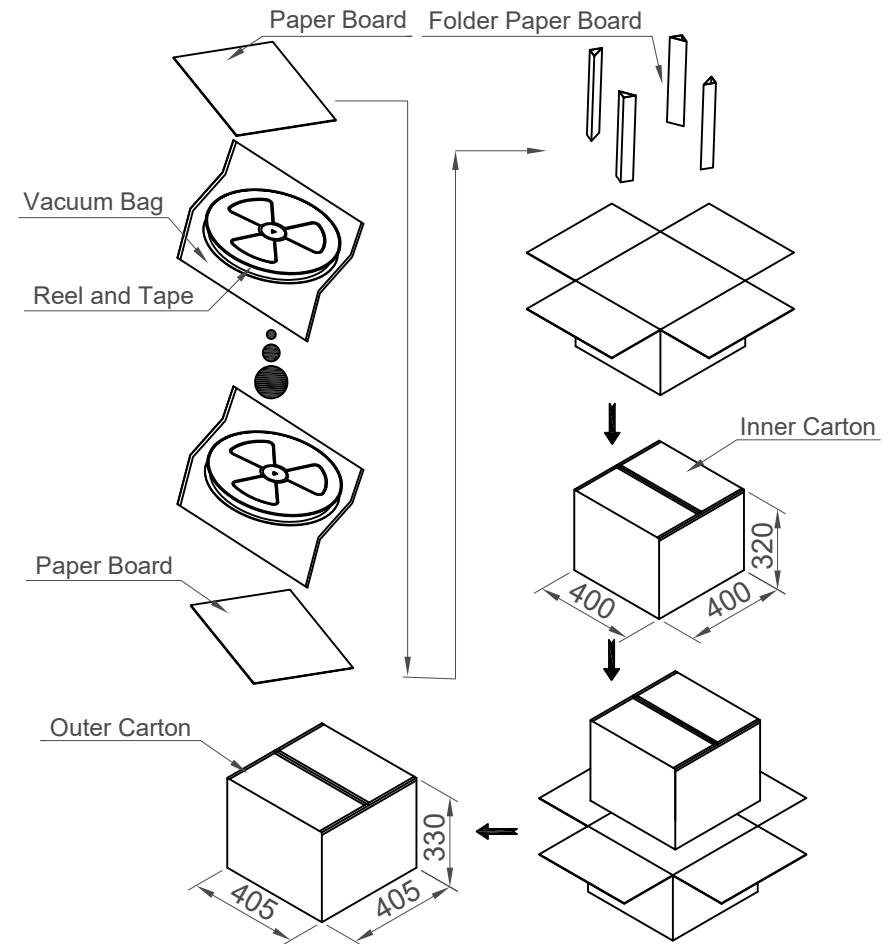
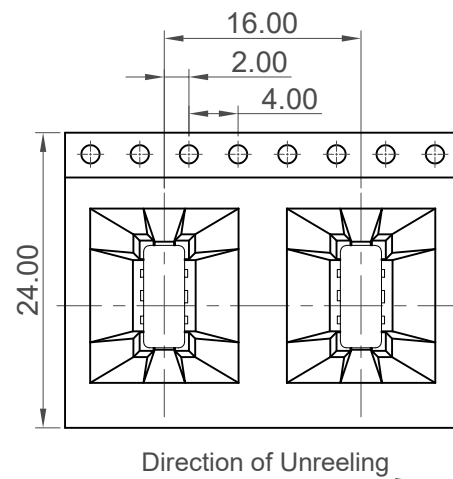
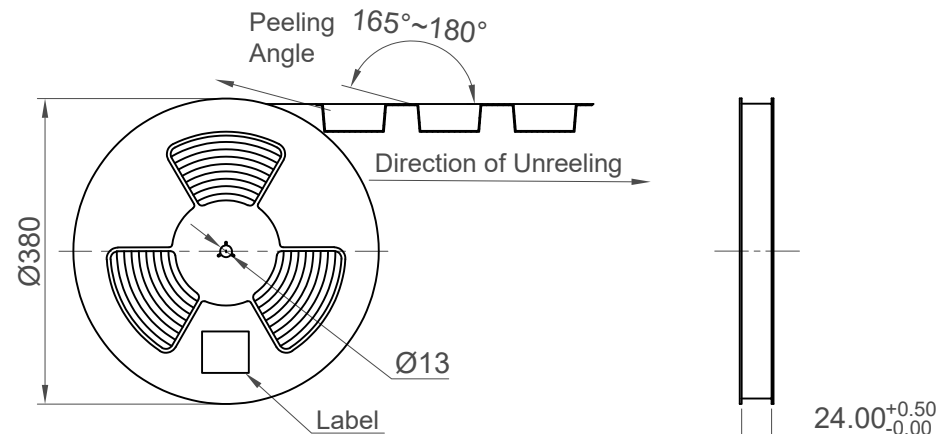
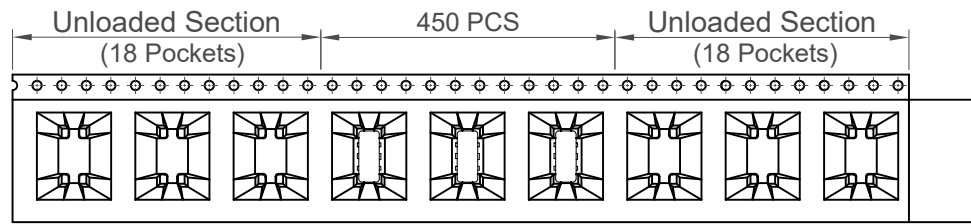

Part Number	Pcs / Reel	Reels / Carton	Total Quantity
USB4220-03-XXXX-C	450	10	4500 pcs

Part Number USB4220		Product Description USB2.0 Type C Receptacle, Vertical, SMT, 16Pin	
Drawing Date 27th June 2024			
By KY	Drawing Release	Tolerances (Except as Noted)	Units: Metric (mm)
Detail		Length	Angle
Revision A		-	-
Date 27/06/24			

RoHS
COMPLIANT
2011/85/EU
Deca-SIDE

This drawing is confidential and copyright of Global Connector Technology, Ltd (GCT). This drawing must not be copied or disclosed without written consent. E & OE

Not to Scale

Drawn By
KY

Sheet No.
3/3

GCT
www.gct.co